

Op#	W x H	From Room	To Room	Door Style
A114	2'x8'	Entry	Powder Bath	3-Panel Single
A116	2'x8'	Coats	Hidden	3-Panel Single
B101	2'-4'x8'	Master Bath	Jan's Closet	3-Panel Single
B102	2'-4'x8'	Master Bath	Bruce's Closet	3-Panel Single
B103	2'-4'x8'	Master Bath	Master Bath	3-Panel Single
B104	2'-4'x8'	Master Bath	Master Vestibule	3-Panel Single
B110	2'-4'x8'	Vestibule Storage	Library Vestibule	3-Panel Single
B122	2'-4'x8'	Food Pantry	Rear Vestibule	3-Panel Single
B131	2'-4'x8'	Exercise W/C	Exercise Bath	3-Panel Single
C130	2'-6'x8'	Exercise/Gameroom	Exercise Bath	3-Panel Single
CB106	3'x8'	Master Vestibule	Master Bedroom	Cased Opening
CB120	4'-6'x8'	Butler Pantry	Family Room	Cased Opening
CB121	4'-6'x8'	Rear Vestibule	Family Room	Cased Opening
CB123	4'-6'x8'	Kitchen	Rear Vestibule	Cased Opening
CB125	4'-4'x8'	Butler Pantry	Breakfast Room	CO - Paneled
CE124	12'x10'	Breakfast Room	Kitchen	CO - Elliptical
CO105	7'-3'x8'	Master Bath	Master Tub	CO - Paneled
CO111	3'-4'x8'	Library Vestibule	Family Room	Cased Opening
CO113	3'-8'x8'	Entry	Family Room	Cased Opening
CO117	3'-8'x8'	Living Vestibule	Living Room	CO - Paneled
CO118	6'x8'	Breakfast Room	Dining	Cased Opening
CO127	4'-4'x9'	Elevator	Hall/ Mudroom	3-Panel Single
D109	2'-8'x8'	Butler Pantry	Hall/ Mudroom	3-Panel Single
D126	2'-8'x8'	Hall/ Mudroom	Utility	3-Panel Single
D134	2'-8'x8'	Hall/ Mudroom	Back Coat	3-Panel Single
D135	2'-8'x8'	Back Coat	Hall/ Mudroom	3-Panel Single
D137	2'-8'x8'	Master Vestibule	Library	Harmon Hinge
E105	2'-8'x8'	Library	Family Room	3-Panel Twin
F108	3'-4'x8'	Kids Desk	Library	3-Panel Twin
G107	3'-6'x8'	Library Storage	Library	3-Panel Twin
G136	3'-6'x8'	Utility Cst	Utility	3-Panel Twin
H129	4'x8'	Exercise Closet	Exercise/Gameroom	3-Panel Twin
J128	5'x8'	Exercise/Gameroom	Hall/ Mudroom	10-Lite 2 Dr Poc
K112	5'-6'x8'	Living Room	Library	3-Panel 2 Dr Poc
L115	2'x8'	Coats	Entry	Hidden
R132	2'x8'	Sauna	Exercise Bath	3-Panel Single
S190	2'-8'x8'	Master Shower	Master Bath	Shower Dr
S191	2'-8'x8'	Exercise Shower	Exercise Bath	Shower Dr
T192	2'x7'	Drip Dry	Utility	Cased Opening
U175	2'x5'-10"	Front Porch	Entry	Single SL Arch U
Y181	2'-10 1/8'x8'-2"	Hall/ Mudroom	Porte Cochere	8-Lite RP Bottom
W180	2'-10 1/8'x9'-1 1/8"	Exercise Bath	Exercise Bath	8-Lite / Transom
X177	4'-7'x9'-3 15/16"	Family Room	Family Room	Twin Arch Trans-K
X178	4'-7'x9'-3 15/16"	Rear Vestibule	Rear Vestibule	8-Lite / Trans-K
Y177	2'-10 1/4'x9'-3 3/4"	Master Bedroom	Master Bedroom	8-Lite / Transom
Z132	5'-2 1/4'x9'-1 1/8"	Exercise/Gameroom	Exercise/Gameroom	Twin Sq Transom

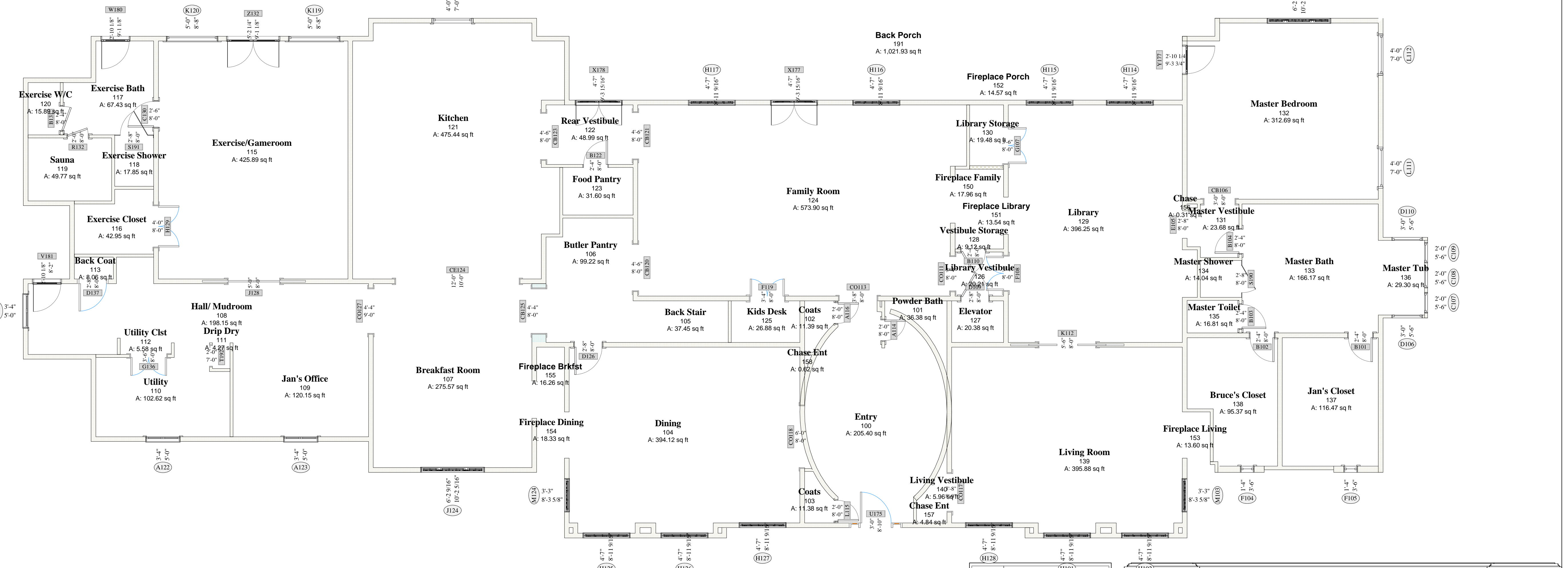

**Door Schedule 1st Floor**

Scale : 3/16" = 1'-0"

Ceiling Frame Height  
Finished Floor Elevation  
Top of Sub Floor

DATE	REMARKS
02/16/04	Pricing Set

Architectural Services for:  
**Dr. & Mrs. Bruce C. Saxon**  
 6677 S. Evanston Circle  
 Tulsa, Oklahoma

Win-06

J Wilson Fuqua & Associates 3402 McFarlin, Suite 214, Dallas, Texas 75205 214.528.4663 8/24/2004